

**TECHNICAL DATA:**

General Data

Force	Max. 1000 N
Speed adjustment	Max. 100 mm/s
Stroke length	Min. 15mm - max. 300mm
Installation dimension (A)	Stroke + 144mm (stroke fixed) Stroke + 184mm (stroke adjustable)
Duty cycle	10%
Position feedback	Optional
Supply voltage	12VDC, 24VDC
Intergrated limit switch	Yes
End position signal	Optional
Protection class	IP54 (static)
Self-locking	Up to nominal load
Storage temperature	-20°C to +60°C

Components

Rod end	POM, hole 10.1mm
Housing end	POM, hole 10.1mm
Lift tube material	Stainless steel
Housing material	POM, anodized aluminum profile
Connection	Cable
Cable length	1,5m
Options	Suspensions individually selectable Special strokes adjustable ex works Special strokes adjustable by customer

More data

Control / Regulation	Voltage polarity
Position feedback	End position feedback potential bound End position feedback potential-free Potentiometer
Monitoring	Current limitation

TECHNICAL DRAWING:

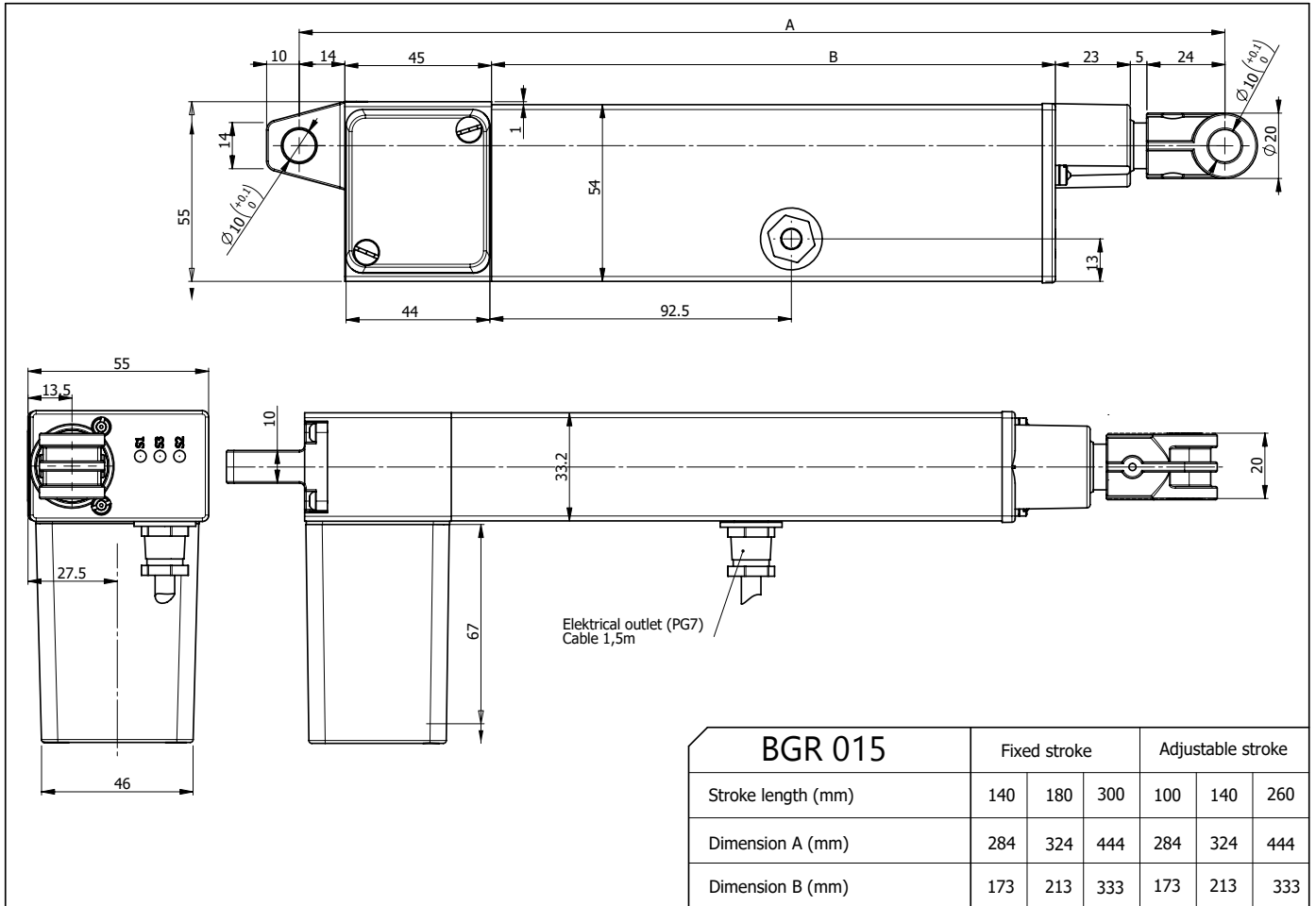



# BGR 015

## PERFORMANCE DATA

